

SCMC, INCORPORATED

1665 West Drive
San Marino, CA 91108
Phone: (626) 299-7000
Fax: (626) 299-7010



1623 El Verano Drive
Thousand Oaks, CA 91362
Phone: (805) 495-1141

CHANGE ORDER REQUEST

PROJECT NAME: Barth Athletics Complex
HMS Phase IIIA

SCMC C.O.R. #: 7
DATE: 5/8/2019

CONTRACTOR: Shenk Developers
210 N. Central Ave. #225
Glendale CA 91203

BID DIVISION #: 3 HVAC
REF. DOC.: HVAC 04R

ITEM DESCRIPTION OF WORK:

Furnish and install wall angle duct supports
Per RFI # 07 response

TOTAL AMOUNT REQUESTED: \$3,581.00

OF DAYS REQUESTED: none

REASON:

Bid Set of plans and specifications did not detail wall angle supports at these locations.
Response given via RFI HVAC #07

[Signature]
PROGRAM MANAGER

5/8/19
DATE

[Signature]
ARCHITECT

5.8.19
DATE

[Signature]
OWNER

5/8/19
DATE

1/9

SCHOOL NAME	HUNTINGTON MIDDLE SCHOOL Phase III	Change Order Proposal
PROJECT NAME	CONSTRUCTION OF BARTH ATHLETIC COMPLEX	
DISTRICT NAME	SAN MARINO UNIFIED SCHOOL DISTRICT	COP#: 04R

Bid # FOI-17/18 - BID DIVISION #4 : PLUMBING

Date: 3/27/2019

Architect: LPA

Project Manager: GERALD SCHOBBER

Contractor: SHENK DEVELOPERS

REVISED

RFI #: 07

CCD #:

DESCRIPTION: SUPPLY & INSTALL 2EA 90X30(1/2) RETURN DUCTS AT CMU WALL WITH 3'X3'X1/4" ANGLE AROUND PERIMETER OF DUCT AS PER DETAIL 9 & RFI #07
(Contractor to provide detailed narrative of Change Order Request work, attach additional pages as required)

Subcontractor Costs (used when work is subcontracted)

Company	Description	Material	Labor	Totals
LIBERTY CLIMATE CONTROL INC.				
PLEASE FIND ATTACHED OUR HVAC SUB-CONTRACTOR'S DETAILED COST BREAKDOWN				3,344.-

Subtotals 3,344.-

Subcontractor OH and Profit (see GC's for %'s) INCLUDED

Subcontractor Subtotal 3,344.-

Contractor OH and Profit (see GC's for 5%'s) 167.-

Subcontractor Total + Contractor Mark-up (Line 1) 3,511.-

Contractor Costs (used when work is self-performed)

Contractor	Description	Material	Labor	Totals

Subtotals 3,511.-

Contractor OH and Profit (15%)

Contractor Total + Contractor Mark-up (Line 2) 3,511.-

Bonding 2% (Line 3) 70.-

TOTAL COSTS FOR COP: 3,581.-

(Line 1 + Line 2 + Line 3)

TOTAL TIME FOR COP: NONE

CONTRACTOR: SHENK DEVELOPERS

Submitted by: [Signature]

Date: 3/27/2019



2447 North Chico Avenue
South El Monte, CA 91733
(626) 575-3131

HVAC COP * 0412

2/9

Change Order

Order#: 4

Order Date: 08/29/2018

To: SHENK DEVELOPERS
210 NORTH CENTRAL AVE #225
GLENDALE CA 91203

Project: 1819
SAN MARINO USD-HUNTINGTON MS
1700 HUNTINGTON DR
SAN MARINO CA 91108

The contractor agrees to perform and the owner agrees to pay for the following changes to this contract.

Plans Attached ☐

Ordered By: 2 CHRISTOPHER GUNTHER

Customer Order:

Specifications Attached ☐

Description of Work	Amount
Material	1,719.71
Labor	1,624.75

Notes

Per RFI No.: 07 response contractor should attached Qty (2) 90x30 (L) return ducts at CMU wall with 3"x3"x 1/4" angle around perimeter of duct per detail 9/-

Design Review Comments:

1a. Review Comment: COP 3, 4, and 5 seem to overlap in scope creating excessive labor hours.

1b. Response: There is no overlap of scope. See bid item breakdowns provided with COR 3, 4 and 5 for detailed list of hours and materials required.

2a. Review Comment: In general they should detail a credit for the original work and deduct that from the cost of the change.

2b. Response: There was no detail on plans for support of 90x30 (L) duct penetrating CMU wall. Cost is for addition of 3"x3" x 1/4" angle support around perimeter of duct not shown on plans at time for bid.

3a. Review Comment: Labor appears to be high for the scope clarification.

3b. Response: 2 men - 1 day (16-hrs.) is accurate for installation of additional support angle.

Negative changes will lower the overall contract price requiring no additional payment by owner.

Requested Amount of Change

3,344.46

The original Contract Sum was	467,000.00
Net change by previous Change Orders	0.00
The Contract Sum prior to this Change Order	467,000.00
The Contract Sum will be changed by this Change Order	3,344.46
The new Contract Sum including this Change Order will be	470,344.46
The Contract Time will be changed by	0 Days

Owner: _____

Date: _____

Contractor: _____

Date: _____

HVAC COP #04R 3/9

Change Order

Order: 4

Continued...

Date: 03/26/2019

Description of Work	Amount
<p>4a. Review Comment: The duct through wall detail is based on SMACNA standards which are referenced on our drawings and industry standard. There should be limited to no cost associated to this clarification.</p> <p>4b. Response: Contractor must follow DSA approved details at time for bid not SMACNA standards. Detail 09/M7.02 did not show installation of 3"x3"x 1/4" angle around perimeter of duct. This angle support was added in RFI response. Contractor should be compensated for additional work not shown on plans at time for bid.</p>	

HVAC COP #04R

4/9

Chris Gunther

From: Shenk Developers <shenkdevelopers@hotmail.com>
Sent: Saturday, September 22, 2018 12:03 PM
To: Chris Gunther
Subject: Fw: Huntington MS Barth Athletic Complex - COP #04; Supports for Return Ducts

Hratch Vorperian
Project Manager
818.281.9541

Shenk Developers
General Contractor
210 N. Central Ave., Suite 225
Glendale, Ca 91203

T:818.500.0990, F:818.500.1418
shenkdevelopers@hotmail.com

From: Gerald Schober <gerald@scmcinc.com>
Sent: Saturday, September 22, 2018 11:56 AM
To: Pete Adame; Shenk Developers
Subject: Fw: Huntington MS Barth Athletic Complex - COP #04; Supports for Return Ducts

Please see Architect's comments and respond

Gerald Schober
SCMC, Inc.
1623 El Verano Drive
Thousand Oaks CA 91362
p 805-495-1141
m 805-390-2962

1665 West Drive
San Marino CA 91108
p 626-299-7000 ext 1393



HVAC COP#04R

5/9

From: Mehta, Nicole <nmehta@lpadesignstudios.com>
Sent: Friday, September 21, 2018 11:02 AM
To: Gerald Schober
Subject: FW: Huntington MS Barth Athletic Complex - COP #04; Supports for Return Ducts

Gerald,

They need to quantify COP 3, 4, and 5. Without clear quantification we are unable to provide a concise evaluation.

See below- I also have comments for 3 and 5.

Thanks,

Nicole Mehta Architect, LEED AP BD+C
Project Manager
Architecture
D: 949.701.4101 O: 949.261.1001



From: Seamark, Doug
Sent: Wednesday, September 19, 2018 5:34 PM
To: Mehta, Nicole <nmehta@lpadesignstudios.com>; Edwards, Terry <tedwards@lpadesignstudios.com>
Subject: RE: Huntington MS Barth Athletic Complex - COP #04; Supports for Return Ducts

Nicole,
For COP 4 here are my comments:

1. COP 3, 4, and 5 seem to overlap in scope creating excessive labor hours.
2. In general they should detail a credit for the original work and deduct that from the cost of the change.
3. Labor appears to be high for the scope clarification.
4. The duct through wall detail is based on SMACNA standards which are referenced on our drawings and industry standard. There should be limited to no cost associated to this clarification.

Thanks,
Doug

Douglas Seamark PE
Project Manager
Associate
Mechanical Engineering
D: 949.701.4092 O: 949.261.1001





License: 327683

LIBERTY CLIMATE CONTROL INC.

2447 North Chico Ave
South El Monte CA 91733
(626) 575-3131

Request For Information

Date of Request: 08/09/2018

RFI#: 7

Prepared By: CHRISTOPHER GUNTHER

To: SHENK DEVELOPERS
210 NORTH CENTRAL AVE #225
GLENDALE CA 91203

Project: 1819
SAN MARNO USD-HUNTINGTON MS
1700 HUNTINGTON DR
SAN MARINO CA 91108

You are hereby invited to provide information on the following items.

Information must be received prior to

to be considered.

☐

☐ Potential Change in
Project Schedule

☐ May require a
Change Order

☐ Requires a Change
of Plans/Specifications

Refer to M2.02 and 2/A3.11 attached

There are two 90x30 (L) return duct branches extending from 28x46 (L) return plenums from units AC-4A & 4B.

The main 28x46 plenum ducts are shown with duct supports either side of branch connections per 09/M7.01 but there are no support shown under 90x30 branch ductwork.

90x30 return ducts extend approx. 5'-0" from gymnasium wall penetration at C-column line.

Do these 90x30 return ducts require supports?

Special Note: duct support detail 09/M7.01 shows maximum duct size as 28w x 48h

Information Supplied:

Add 45's to bring supply duct close to wall per RFI #06. For return ductwork, please see attached sketch (page 4) detailing attachment from duct to exterior wall. No additional duct supports required.

T. Edwards, LPA
08/20/18

2/2

M2.02

#VAC COP#0412

DATE	1/1/2000
TIME	1:00 PM
BY	1
REVISION	1
DESCRIPTION	1
DATE	1/1/2000
TIME	1:00 PM
BY	1
REVISION	1
DESCRIPTION	1

REVISION RECORD
REVISION

HUNTINGTON MIDDLE SCHOOL
SUN MOUNTAIN, OKLA 74133
1700 N. HUNTINGTON
SUN MOUNTAIN, OKLA 74133

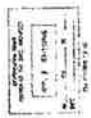

LPA

1. DESIGNER
2. CHECKER
3. APPROVER
4. DATE
5. TIME
6. BY
7. REVISION
8. DESCRIPTION

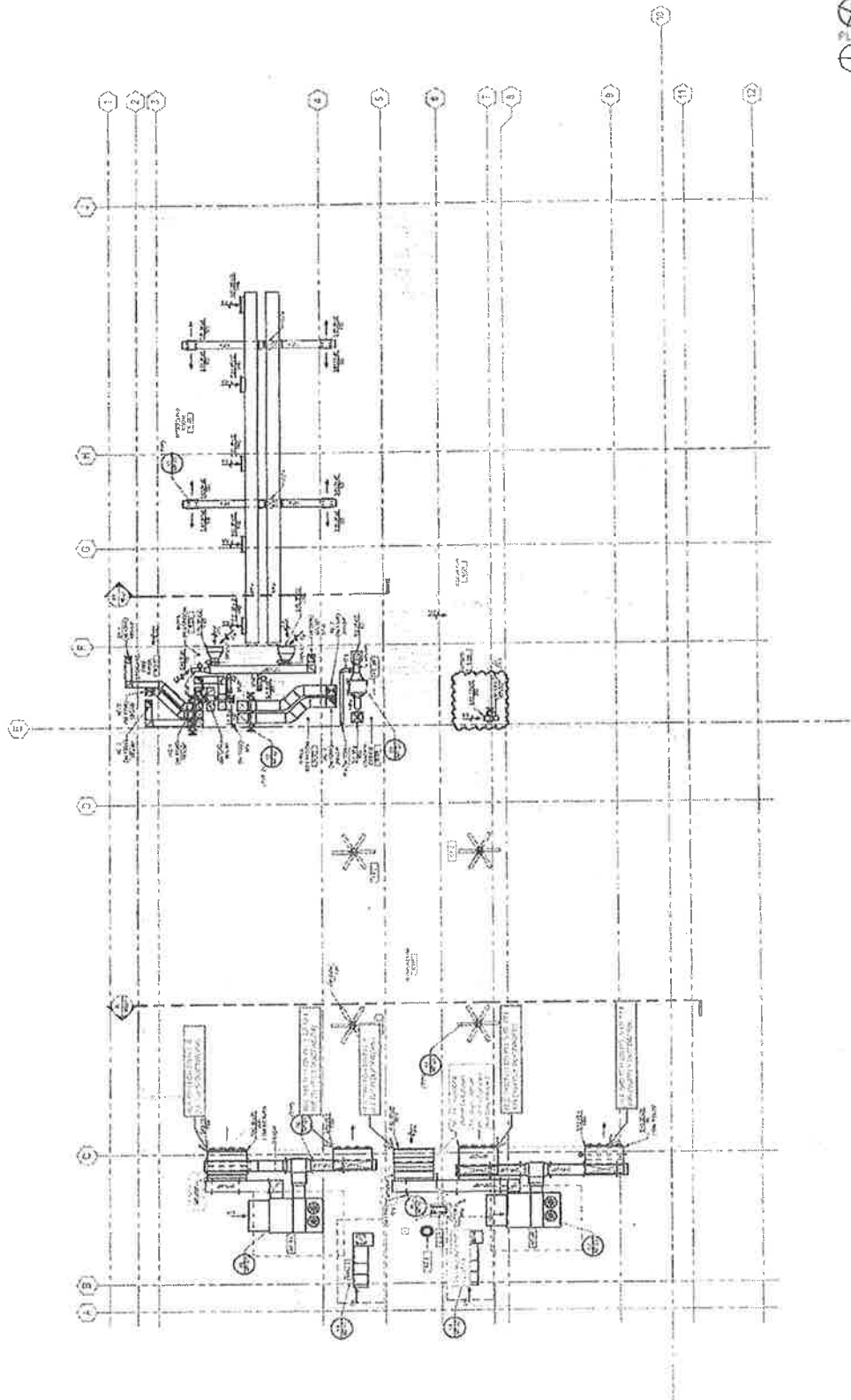
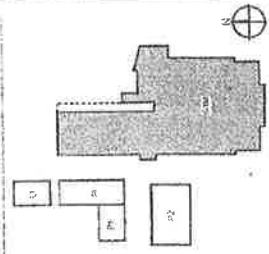

ITEM	DESCRIPTION	QUANTITY	UNIT	PRICE	TOTAL
1
2
3
4
5
6
7
8
9
10
11
12
13
14
15
16
17
18
19
20
21
22
23
24
25
26
27
28
29
30
31
32
33
34
35
36
37
38
39
40
41
42
43
44
45
46
47
48
49
50

